

# Wisconsin State Laboratory of Hygiene

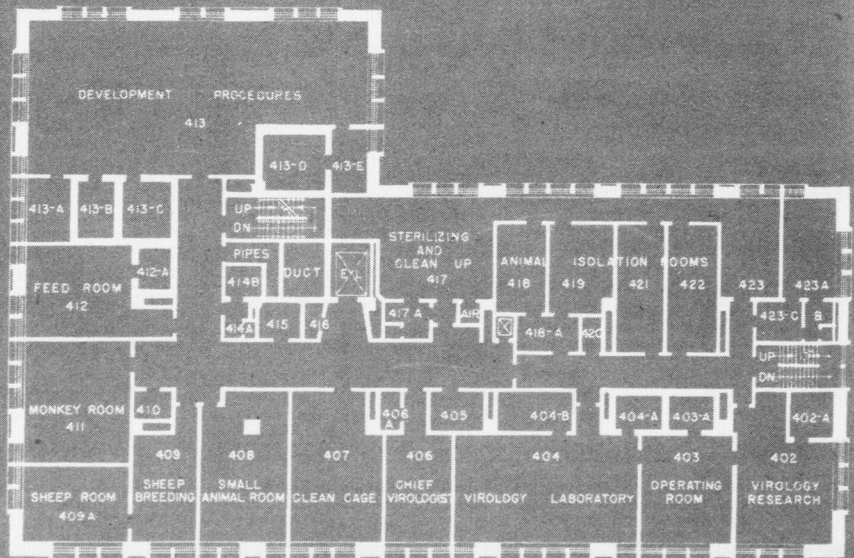

see overleaf

## **frontispiece . . .**

The new building for the Wisconsin State Laboratory of Hygiene, located on the campus of the University of Wisconsin at Madison, forms an integral part of the University Medical Center. All the various laboratories of the Wisconsin State Board of Health, which were formerly located in several campus buildings, are now housed under one roof. All laboratory services are departmentalized.

Dr. W. D. Stovall, past president of the Wisconsin State Medical Society, is director of the laboratory, with which he has been associated since 1913 and which was first established in 1903 when bacteriology was still a new-born science. The Wisconsin laboratory was one of the first laboratories in this country to provide clinical pathology services. The laboratory operates under a form of joint control by the Wisconsin State Board of Health and the University of Wisconsin.

# PUBLIC HEALTH REPORTS



G. ST. J. PERROTT, *Managing Director*  
*Acting Executive Editor*  
*Chief, Division of Public Health Methods*

## EDITORS

*Chairman of the Board of Editors*  
EDWARD G. MCGAVRAN, M.D., M.P.H.  
*Chapel Hill*

TAFT S. FEIMAN  
*Managing Editor*

WINONA E. CARSON  
*Asst. Managing Editor*

## BOARD OF EDITORS

GAYLORD W. ANDERSON, M.D., DR.P.H.  
*Minneapolis*

JOHN W. KNUTSON, D.D.S., DR.P.H.  
*Washington*

JUSTIN M. ANDREWS, Sc.D., LL.D.  
*Washington*

BASIL C. MACLEAN, M.D., M.P.H.  
*Rochester, N.Y.*

HALBERT L. DUNN, M.D., PH.D.  
*Washington*

M. ALLEN POND, M.P.H.  
*Washington*

MARTHA M. ELIOT, M.D., Sc.D.  
*Washington*

FILLMORE SANFORD, PH.D.  
*Washington*

RUTH FREEMAN, R.N., Ed.D.  
*Baltimore*

GEORGE M. UHL, M.D., M.S.P.H.  
*Los Angeles*

RUSSELL M. WILDER, M.D., PH.D.  
*Rochester, Minn.*

U. S. DEPARTMENT OF HEALTH, EDUCATION, AND WELFARE

OVETA CULP HOBBY, *Secretary*

PUBLIC HEALTH SERVICE

LEONARD A. SCHEELE, *Surgeon General*

PUBLIC HEALTH SERVICE  
NATL INSTITUTE OF HEALTH  
EDITORIAL SECTION, HEAD  
154 BLDG 1  
569 BETHESDA 14 MARYLAND

S  
GOVERNMENT PRINTING OFFICE  
DIVISION OF PUBLIC DOCUMENTS  
WASHINGTON 25, D. C.

PENALTY FOR PRIVATE USE TO AVOID  
PAYMENT OF POSTAGE, \$300  
(GPO)

OFFICIAL BUSINESS

If you do not desire to continue receiving this publication, please CHECK HERE ;  
tear off this label and return it to the above address. Your name will then be  
promptly removed from the appropriate mailing list.

PHR